

Key:	
	Line of Works
	Works Area
	Road Closure
	Diversion Route
	Cone
	Pedestrian Barrier
	Temporary Sign
	Temporary Traffic Signal
	Stop & Go Board
	Permanent Traffic Signal
	Temporary Ped Signal
	Existing Bus Stop
	3.5t Van

Notes:	
Min width of sideways safety zone (S)	0.5m
Min length of longways clearance (L)	0.5m

ONE WAY SYSTEM TO BE REVOKED
EXISTING PERMANENT SIGNAGE TO
BE BAGGED/SPRAYED OUT AND TWO
WAY TRAFFIC SIGNS TO BE INSTALLED

All signage erected on
footways to ensure a
minimum width of 1m
clearance for pedestrians.

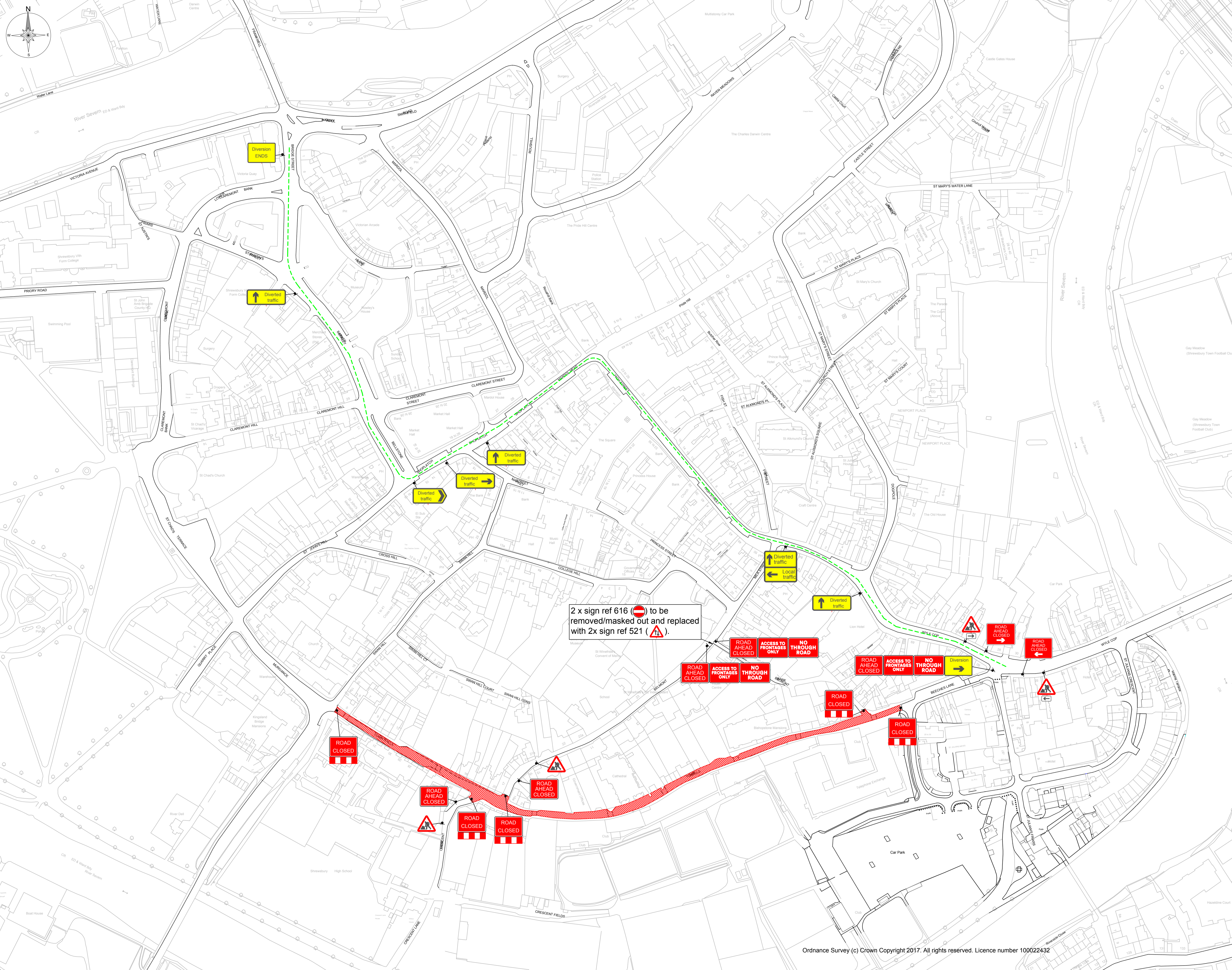

Date	Comments	By

McPHILLIPS
Working in Partnership with
traffix
total traffic & event management solutions
Old Arden Brickworks | Bickenhill | Solihull | West Midlands | B92 0DY
1 +44 (0)800 819 9001 | +44 (0)121 75 442507
info@traffix.com | www.traffix.com

Project title: S.I.T.P - Town Walls Resurfacing Phase 1		
Drawing title: Road closure & one way system reversal Town Walls Shrewsbury SY1 1TN		
Date: 25/02/2019	Scale: 1:1250	Paper: A1
Drawn: MO	Checked: BNH	Approved: SA
Project Number: TFX SA4517	Drawing Number: 012	Revision: -

This drawing is copyright & the property of Traffix & must not be copied in whole or in part without their written permission. Copyright is reserved. © This drawing must not be scaled. The Contractor is to report all discrepancies & errors to the Contract Manager prior to works commencing.

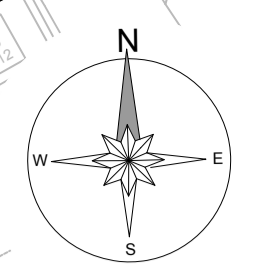

Key:	
	Line of Works
	Works Area
	Diversion Route
	Cone
	Pedestrian Barrier
	Temporary Sign
	Temporary Traffic Signal
	Stop & Go Board
	Permanent Traffic Signal
	Temporary Ped Signal
	Existing Bus Stop
	3.5t Van

Notes:	
Min width of sideways safety zone (S)	0.5m
Min length of longways clearance (L)	0.5m

ONE WAY SYSTEM TO BE REVOKED
EXISTING PERMANENT SIGNAGE TO BE BAGGED/SPRAYED OUT AND TWO WAY TRAFFIC SIGNS TO BE INSTALLED

All signage erected on footways to ensure a minimum width of 1m clearance for pedestrians.

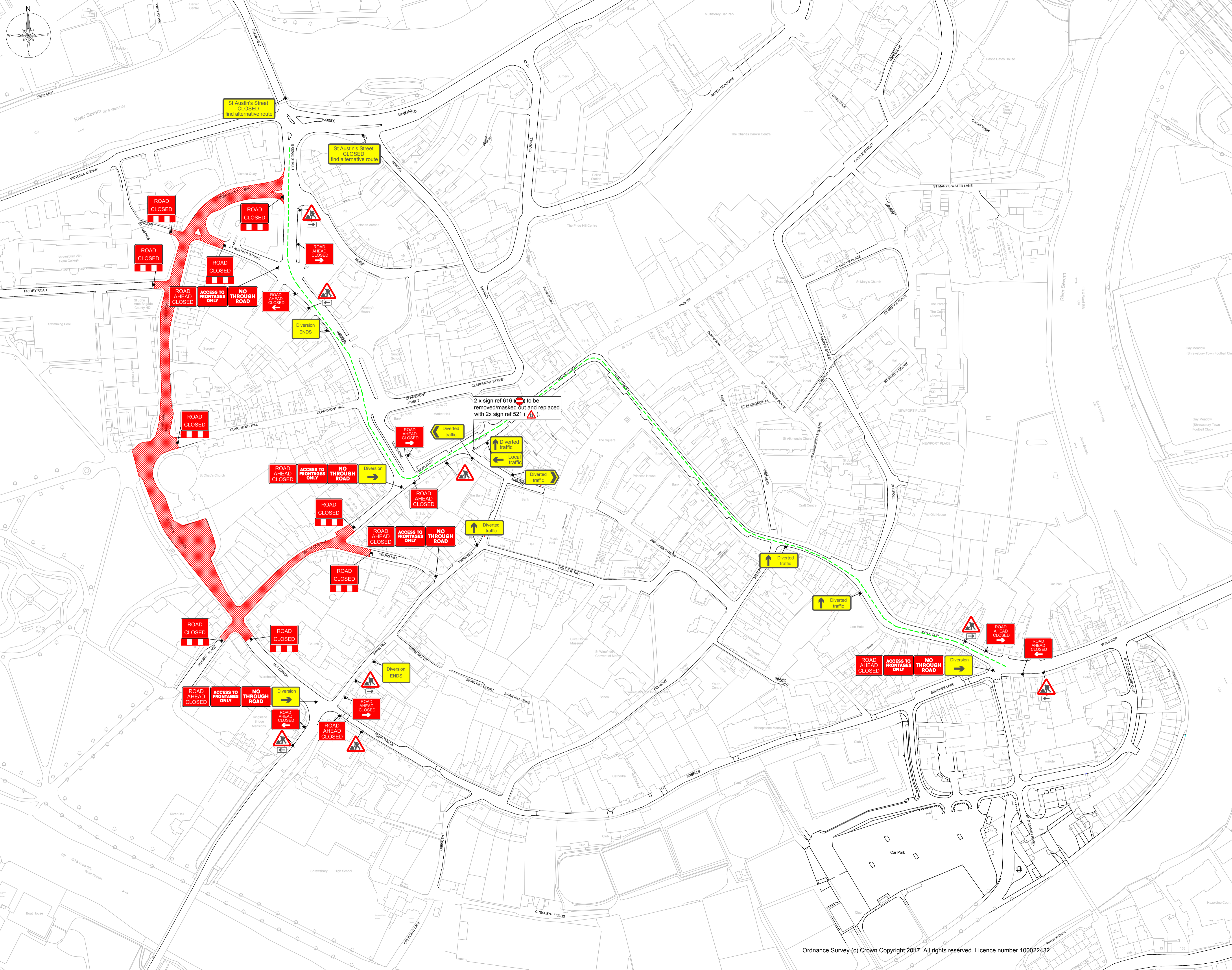

Rev	Date	Comments	By	CHK

McPHILLIPS
Working in Partnership with
traffix
total traffic & event management solutions
Old Arden Brickworks | Bickenhill | Solihull | West Midlands | B92 0DY
t +44 (0)800 819 9001 | f +44 (0)121 75 442507
info@traffix.com | www.traffix.com

Project title: S.I.T.P - Town Walls Resurfacing Phase 2		
Drawing title: Road closure & one way system reversal Town Walls Shrewsbury SY1 1TN		
Date: 25/02/2019	Scale: 1:1250	Paper: A1
Drawn: MO	Checked: BNH	Approved: SA
Project Number: TFX SA4517	Drawing Number: 013	Revision: -

This drawing is copyright & the property of Traffix & must not be copied in whole or in part without their written permission. Copyright is reserved. © This drawing must not be scaled. The Contractor is to report all discrepancies & errors to the Contract Manager prior to works commencing.

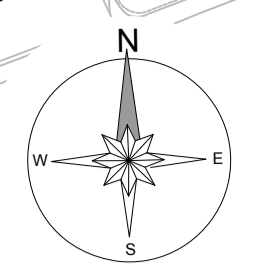

**SEE DRAWING
001-2 FOR
DIVERSION ROUTE**

Key:	
	Line of Works
	Works Area
	Road Closure
	Diversion Route
	Cone
	Pedestrian Barrier
	Temporary Sign
	Temporary Traffic Signal
	Stop & Go Board
	Permanent Traffic Signal
	Temporary Ped Signal
	Existing Bus Stop
	3.5T Van

Notes:	
Min width of sideways safety zone (S)	0.5m
Min length of longways clearance (L)	0.5m

Closure point to be manned to allow access to Quarry Place. All vehicle are to be escorted through the works

B	17/10/2018	Additional changes as per WSP request	MO	SA
A	10/10/2018	Additional signage added as per L.A. instruction	MO	SA
Rev	Date	Comments	By	CHK

McPHILLIPS
Working in Partnership with
traffix
total traffic & event management solutions
Old Arden Brickworks | Bickenhill | Solihull | West Midlands | B92 0DY
t +44 (0)950 819 9001 | f +44 (0)1675 442507
info@traffix.com | www.traffix.com

Project title: S.I.T.P - Town Walls			
Drawing title: Proposed Road Closure and Diversion Town Walls Shrewsbury SY1 1TN			
Date: 05/10/2018	Scale: NTS	Paper: A1	
Drawn: MO	Checked: CM	Approved: SA	Revision: B
Project Number: TFX SA4517	Drawing Number: 001-1		

This drawing is copyright & the property of Traffix & must not be copied in whole or in part without their written permission. Copyright is reserved. © This drawing must not be scaled. The Contractor is to report all discrepancies & errors to the Contract Manager prior to works commencing.

Ordnance Survey (c) Crown Copyright 2017. All rights reserved. Licence number 100022432

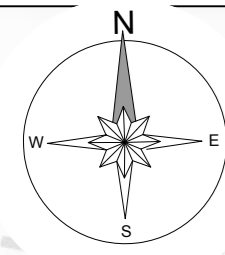
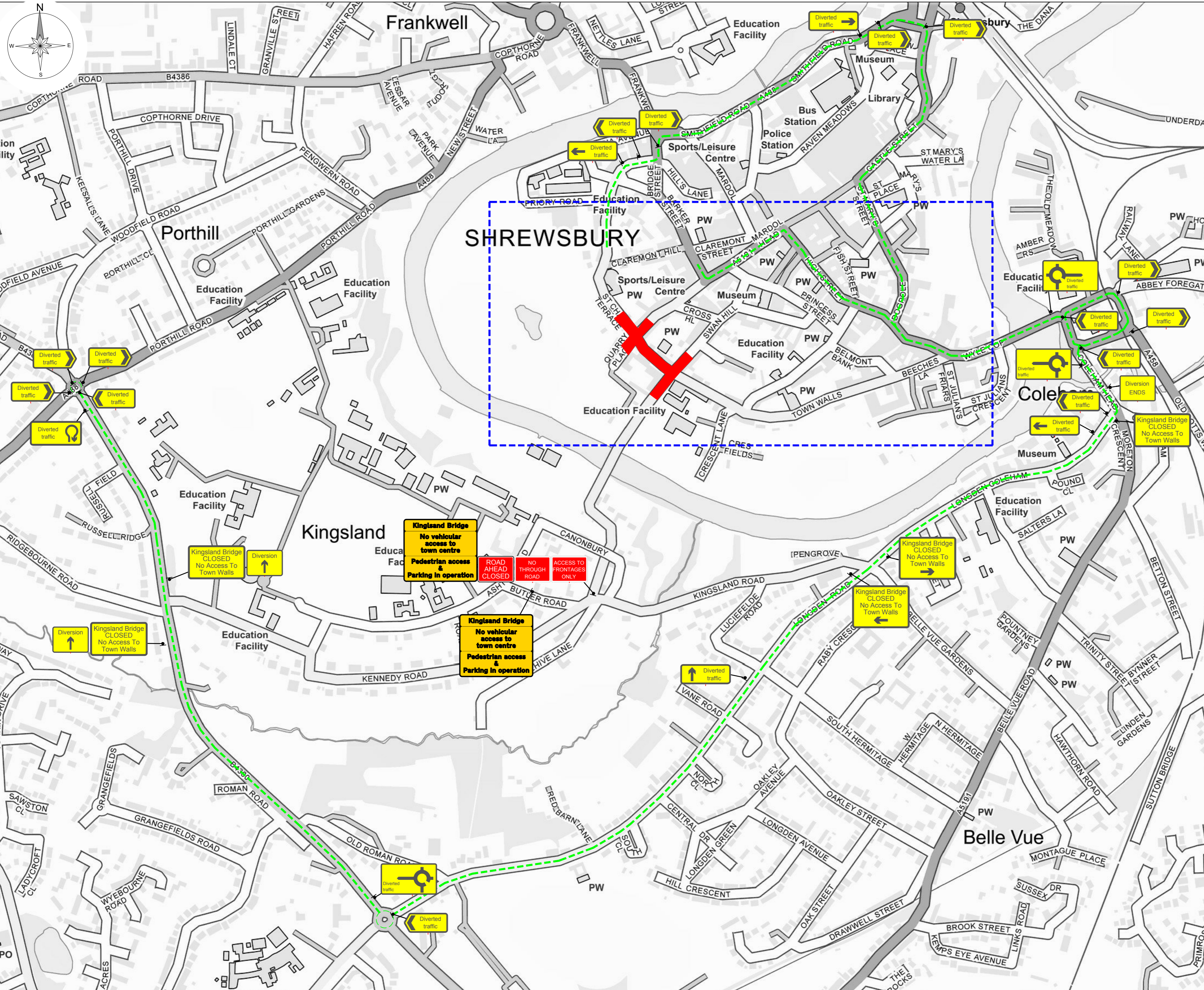

Key:

	Line of Works		Temporary Traffic Signal
	Works Area		Stop & Go Board
	Road Closure		Permanent Traffic Signal
	Diversion Route		Temporary Ped Signal
	Cone		Existing Bus Stop
	Pedestrian Barrier		3.5T Van
	Temporary Sign		

Notes:

Min width of sideways safety zone (S)	
Min length of longways clearance (L)	

Rev	Date	Comments	By	CHK
B	23/10/2018	Additional signage added as per L.A instruction	MO	SA
A	10/10/2018	Additional signage added as per L.A instruction	MO	SA

McPHILLIPS
 Working in Partnership with
traffix
 total traffic & event management solutions
 Old Arden Brickworks | Bickenhill | Solihull | West Midlands | B92 0DY
 t +44 (0)800 819 9001 | f +44 (0)1675 442507
 info@traffix.com | www.traffix.com

Project title:
S.I.T.P - Town Walls

Drawing title:
Proposed Road Closure and Diversion
Town Walls
Shrewsbury
SY1 1TN

Date:	05/10/2018	Scale:	NTS	Paper:	A2
Drawn:	MO	Checked:	CM	Approved:	SA
Project Number:	TFX SA4517	Drawing Number:	001-2	Revision:	B

This drawing is copyright & the property of Traffix & must not be copied in whole or in part without their written permission. Copyright is reserved. ©
 This drawing must not be scaled.
 The Contractor is to report all discrepancies & errors to the Contract Manager prior to works commencing.